

Linsenschraube W1452 M4x18 mm, Stahl verzinkt, 10er-Pack - Bosch Rexroth 3842552422

Item no. BRR-3842552422 **Manufacturer** Bosch Rexroth**Manufacturer no.** 3842552422

Oval-head screw to W1452 specification, M4x18 mm, galvanized steel, strength class 10.9 with Torx T20 drive. Designed for EcoSlide assembly systems; supplied in packs of 10.

TECHNICAL DATA

Article authenticity	Original product
Condition of article	New
Country of Manufacture	Germany
Weight	0.002 kg
Zolltarifnummer	73181499

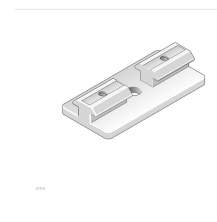

DESCRIPTION

The W1452 oval-head screw in M4x18 mm is a genuine Bosch Rexroth EcoSlide accessory, combining a low-profile head with the high clamping force of strength class 10.9. The Torx T20 drive allows precise torque application in aluminum profiles and plastic components without cam-out risk.

- Low oval head - minimal clearance requirement alongside adjacent EcoSlide guide elements
- Strength class 10.9 - high clamping force for a compact M4 fastener
- Torx T20 drive - efficient torque transfer, reduces tool slip during tightening
- Galvanized steel - corrosion protection suited to industrial assembly environments
- Pack of 10 - convenient stock quantity for assembly line use

Technical data

Property	Value
Type	Oval-head screw W1452
Thread size	M4
Length	18 mm
Strength class	10.9
Drive	Torx T20

Property	Value
Material	Steel, galvanized
Weight	0.002 kg per piece
Packaging unit	10 pieces