

Basiseinheit 65+ STS Connect DIR, Breite 65 mm, Edelstahlgehäuse, VarioFlow plus - Bosch Rexroth 3842553914

Item no. BRR-3842553914 **Manufacturer** Bosch Rexroth

Manufacturer no. 3842553914

Fully assembled base unit for the VarioFlow plus stainless steel system (STS) in size 65 mm with direct connection (DIR). Housing, connectors, chain fender and ball bearings in stainless steel 1.4301 - suited for cleanroom, food and pharmaceutical conveyor applications. Delivered ready to install, including all fastening material.

TECHNICAL DATA

Article authenticity	Original product
Condition of article	New
Country of Manufacture	Germany
ESD-Ausführung	TEC
Weight	14.42 kg
Zolltarifnummer	84313900

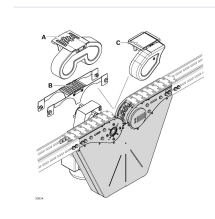

STANDARDS & COMPLIANCE

ESD safe

DESCRIPTION

The Base Unit 65+ STS Connect DIR is the central drive and deflection module for the VarioFlow plus stainless steel chain conveyor system by Bosch Rexroth. With a build width of 65 mm and an effective chain length of 1.51 m, it provides a ready-to-install foundation for conveyor lines in hygiene-critical environments such as food processing, pharmaceuticals and cleanroom production.

- Housing, connectors, chain fender and ball bearings (1.4301/FDA) in stainless steel - corrosion-resistant and easy to clean
- Chain wheel, chain guide and hexagonal shaft in PA - smooth-running with low noise and wear
- Total effective sliding rail length 4 x 0.2 m (0.8 m combined)
- Fully assembled and ready to install, including all fastening material
- STS Connect DIR interface for direct integration into the modular VarioFlow plus system

Technical data

Specification	Value
Size [b]	65 mm
Effective chain length	1.51 m
Total effective sliding rail length	4 x 0.2 m
Weight	14.42 kg
Housing	Non-rusting steel 1.4301
Connector	Non-rusting steel 1.4301
Chain fender	Non-rusting steel 1.4301
Ball bearing	Non-rusting steel 1.4301/FDA
Chain wheel	PA
Chain guide	PA
Hexagonal shaft	PA
Scope of delivery	Incl. fastening material, fully assembled