

Basiseinheit 90+ STS Connect DIR, Breite 90 mm, Edelstahl 1.4301, VarioFlow plus - Bosch Rexroth 3842553915

Item no. BRR-3842553915 **Manufacturer** Bosch Rexroth

Manufacturer no. 3842553915

Fully assembled drive base unit for the VarioFlow plus stainless steel chain conveyor system STS, size 90 mm. Housing, connectors and ball bearings in stainless steel 1.4301; chain length 1.51 m - ready for installation in hygiene-critical and corrosive environments.

TECHNICAL DATA

Article authenticity	Original product
Condition of article	New
Country of Manufacture	Germany
ESD-Ausführung	TEC
Weight	14.72 kg
Zolltarifnummer	84313900

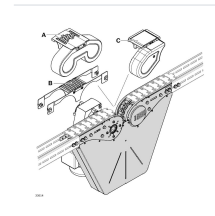

STANDARDS & COMPLIANCE

ESD safe

DESCRIPTION

The Base Unit 90+ STS Connect DIR is the pre-assembled direct chain drive element for the VarioFlow plus stainless steel conveyor system in size 90 mm. Delivered fully assembled and complete with fastening material, it is ready to install without additional preparation.

- **Corrosion-resistant design:** Housing, connectors, ball bearings and chain fender in stainless steel 1.4301 - suitable for wet areas, cleanrooms and food-processing environments.
- **Ready to install on delivery:** Fully assembled including all fastening hardware; minimal on-site assembly effort.
- **Guided chain travel:** Four sliding rails of 0.2 m each (0.8 m total effective length) ensure smooth, guided chain movement.
- **FDA-compliant bearing:** Ball bearing in stainless steel 1.4301/FDA for applications with

incidental food contact.

Technical data

Specification	Value
Size [b]	90 mm
Actual chain length	1.51 m
Effective sliding rail length	4x 0.2 m
Weight	14.72 kg
Housing	Stainless steel 1.4301
Chain wheel	PA
Chain guide	PA
Connector	Stainless steel 1.4301
Hexagonal shaft	PA
Ball bearing	Stainless steel 1.4301/FDA
Chain fender	Stainless steel 1.4301
Scope of delivery	Incl. fastening material
Delivery information	Fully assembled