

# Basiseinheit 65+ AL Kurvenrad WH ESD, 180° - Bosch Rexroth 3842553037

**Item no.** BRR-3842553037 **Manufacturer** Bosch Rexroth

**Manufacturer no.** 3842553037

Base unit for the VarioFlow plus ESD chain conveyor system in size 65, featuring a die-cast aluminium housing and an ESD-compliant PA chain wheel. Covers an effective chain length of 0.68 m and is supplied unassembled with fastening material included.

## TECHNICAL DATA

Article authenticity	<b>Original product</b>
Condition of article	<b>New</b>
Country of Manufacture	<b>Germany</b>
ESD-Ausführung	<b>ESD (antistatic)</b>
Weight	<b>0.1 kg</b>
Zolltarifnummer	<b>84313900</b>

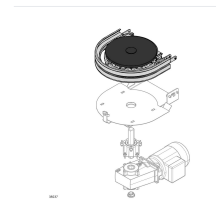

## STANDARDS & COMPLIANCE

**ESD safe**

## DESCRIPTION

The Base Unit 65+ AL Curve Wheel WH ESD is the central drive and deflection element for curved sections in the VarioFlow plus ESD chain conveyor system. It is designed for ESD-protected assembly and production lines where static discharge control is required along the entire conveyor path.

- **ESD-safe chain wheel:** the PA ESD (black) chain wheel safely dissipates electrostatic charges, protecting sensitive assemblies throughout the line.
- **Rigid aluminium housing:** die-cast aluminium construction combines low weight with high rigidity and lasting corrosion resistance in industrial environments.
- **FDA-rated ball bearing:** non-rusting steel 1.4301/FDA bearings suit hygiene-sensitive or cleanroom-adjacent applications.
- **Ready to integrate:** fastening material is included; the drive kit curve wheel, assembly module, slide rail, and leg set are required accessories ordered separately.

## Technical data

Attribute	Value
Size [b]	65 mm
Actual chain length	0.68 m
Effective sliding rail length	0.82 m
Housing	Die-cast aluminium
Chain wheel	PA ESD, black
Ball bearing	Non-rusting steel 1.4301/FDA
Delivery condition	Not assembled, incl. fastening material
Required accessories	Drive kit curve wheel, assembly module, slide rail, leg set
Recommended accessories	Connection kit alpine conveyor
Weight	5.4 kg