

T-Stück Kabelkanal 80x80x40 mm, Signalgrau RAL 7004, ESD - Bosch Rexroth 3842558653

Item no. BRR-3842558653 **Manufacturer** Bosch Rexroth

Manufacturer no. 3842558653

T-piece for branching Bosch Rexroth cable duct runs, dimensions 80x80x40 mm. The PP housing in signal gray (RAL 7004) supports ESD applications: the included potential equalizer cable connects two duct sections conductively. Tool-free assembly via push-in connecting elements, VDE certified.

TECHNICAL DATA

Article authenticity	Original product
Condition of article	New
Country of Manufacture	Italy
Weight	0.22 kg
Zolltarifnummer	84879090

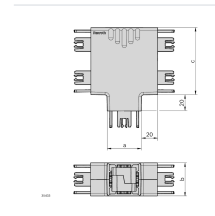

STANDARDS & COMPLIANCE

ESD safe

DESCRIPTION

The T-piece cable duct 80x80x40 mm from Bosch Rexroth branches cable management runs in assembly and production environments. Sections connect tool-free with push-in elements; the supplied potential equalizer cable links two duct segments conductively - VDE certified and suitable for ESD-sensitive workplaces.

- Modular design: duct sections joined quickly with push-in connecting elements
- ESD-suitable: conductive potential equalization between two duct sections via included cable
- VDE certified
- Scope of delivery: T-piece, connecting elements and potential equalizer lines

Technical data

Parameter	Value
Type	T-piece cable duct
Dimension a	80 mm
Dimension b	80 mm
Dimension c (branch)	40 mm
Material	PP (polypropylene)
Color	Signal gray RAL 7004
ESD	yes
Notice	Plastic has no inherent conductivity; using the potential equalizer, 2 duct sections can be connected conductively
Certification	VDE
Scope of delivery	T-piece, connecting elements, potential equalizer lines
Weight	0.22 kg